

A cached 2 door reader module for **CONCEPT 4000** systems



A simple and economical way to bring a measure of redundant access control to your Concept system

- Automatically stores the last 110 users through each door for use in offline situations
- Stores 35 additional fixed system wide users
- Dynamic updating of users without installer programming
- Each Cached 2 Door Module maintains its own individual record of users per door independent of the other modules in the system

The Cached 2 Door Access Module is an economical two door, two card reader access module. It can control two doors with two readers, or one door with in and out readers with the added benefit of a dynamic on board memory that continually logs the last 110 users through each door. In the event that contact with the Control Module is lost, this Cached 2 Door Access Module allows access to the last 110 logged users until such time as contact with the Control Module is re-established.

Flexibility Plus

Readers can be configured independently allowing mixed technologies on the one Module.

Enterprise Level Access Control

As with the normal 2 Door Access Module, this cached version fully supports all of the advanced Concept access control features while it is online to the Control Module: i.e. soft / hard / timed anti-passback, dual user, card and PIN, free access via timezones etc. These features are not available however, when this module operates in offline mode. If full system redundancy is required in offline mode, installation of an Inner range Concept 4000 Intelligent 4 Door Access Module is required.

Features:

- Supports magnetic swipe or Wiegand card readers without the need for an additional interface
- Cache mode version supports offline database of 110 dynamic users and 35 programmed system wide backup users
- Provides reed and tongue sense monitoring
- Request to Enter (REN), Request to Exit (REX) & Arm inputs provided
- Door Open Too Long (DOTL), valid and invalid outputs
- On-board lock relays
- Fuse protection of Reader head power

Connectivity

The Cached 2 Door Access module is connected directly to the Concept RS485 LAN. Up to 99 of the Cached 2 Door Access modules may be installed in a single panel system.

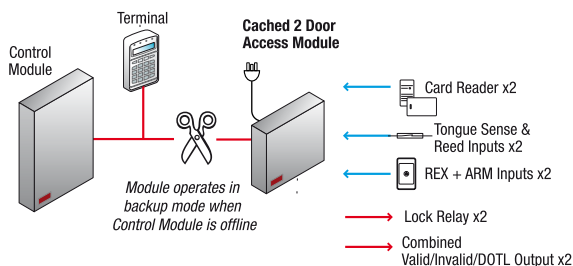

SPECIFICATIONS

Physical

995012	305(L) x 140(W) x 72(D) (mm)
995012PS / 995012CAPS	252(L) x 358(W) x 85(D) (mm)
Installation Environment	0°C - 40°C @15 - 85% Relative humidity (non-condensing)

Electrical

Input Voltage to PCB	11-14V DC (Typically from separate power supply)
Operational Current	70mA (No relays active and no external load)
Max	210mA
Fuse Protection	500mA

Inputs

Zone Inputs	7 (May have predefined functions depending on programming options selected, i.e.: Door Reed, REX, REN, Tongue Sense and Arm button)
Reader Ports	2

Outputs

Relay	2 (Typically used for door locks)
Outputs (open collector)	4 (Typically used for Valid/Invalid indication)
DOTL pre-warn	2 (1 per door)

Ordering options

995012CAPS

2 Door Access Module with offline cache mode and power supply in metal enclosure

995012CAPCB&K

2 Door Access Module with offline cache mode short form kit

Distributed By: